

FIVE-AXIS COMPACT MULTI-POWER VISE

Model: ACM-130, 160

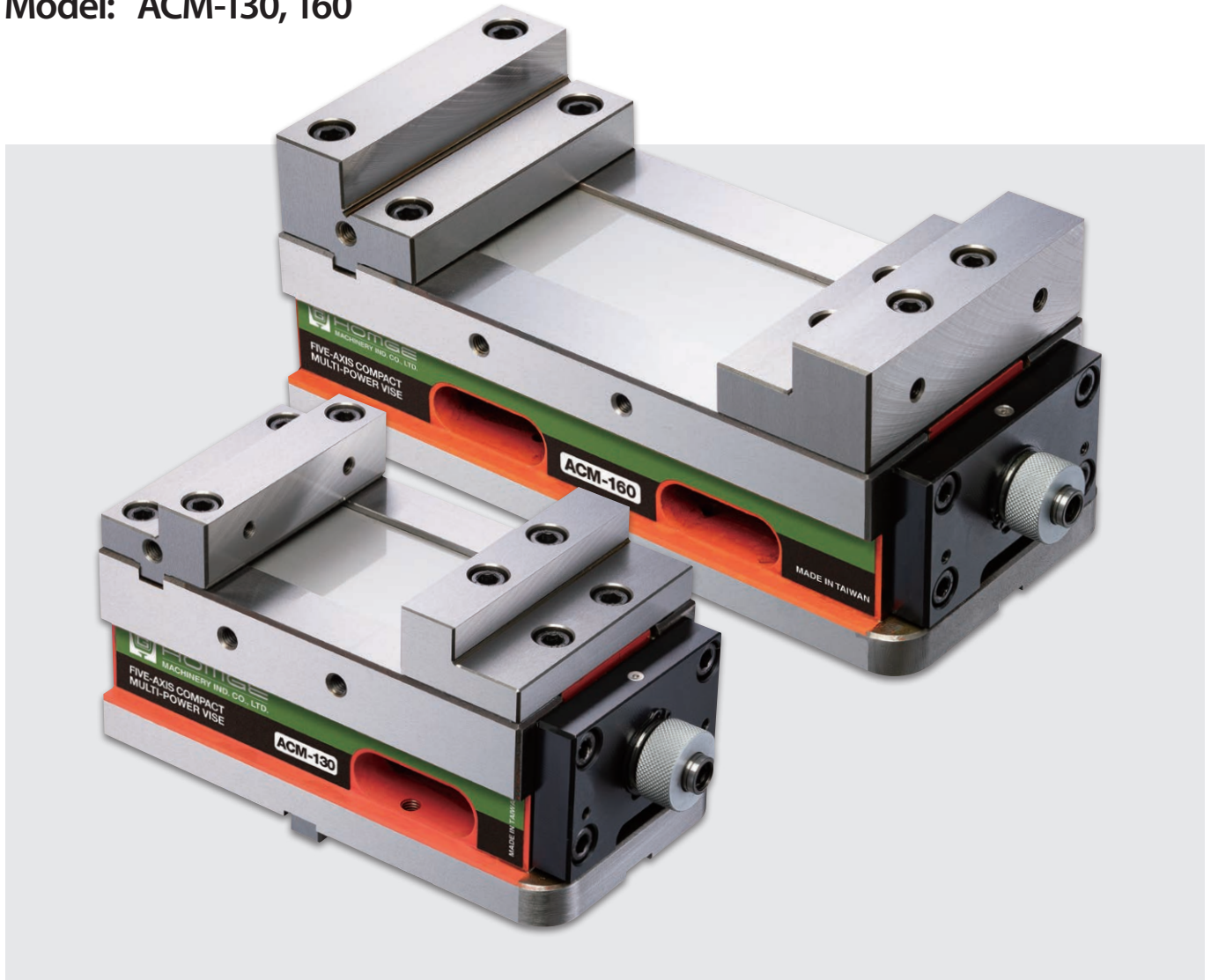

- Suitable for CNC 5-Axis Machining Centers, horizontal and vertical CNC Machining Centers
- Shortest Length with **Big Jaw Opening**
- Extremely High Accuracy and Repeatability
- Special MULTI-POWER design enhances clamping force of **0~5000KG**



STANDARD ACCESSORIES:

- 2 pcs of Alignment Wedge
- 4 pcs of Clamp
- 1 pc of Wrench

OPTIONAL ACCESSORIES:

- Serrated Jaws
- Soft Jaws

<p>Constructed from High Grade BEARING STEEL, the patented MULTIPOWER SYSTEM doubles the clamping force of the vise, offering a clamping force range of 0 to 5000kg. Additionally, this system guarantees a consistent application of pressure, effectively eliminating concerns related to oil leakage commonly associated with hydraulic vises.</p>	<p>Compact design with big jaw opening, which enhances machine space utilization.</p>	<p>Special Leadscrew Covers protect Leadscrew from swarf and avoid any possible damage to internal parts.</p>	<p>Vise jaws are made of High quality Tool Steel (SCM440) and Hardened to achieve HRC 55, which makes vise clamp the workpieces easily and firmly.</p>	<p>Vise body is made of Ductile Iron above FCD 60 grade and its slideways are hardened to HRC 52, which increase the tensile strength of the vise to ensure clamping accuracy.</p>
1	2	3	4	5

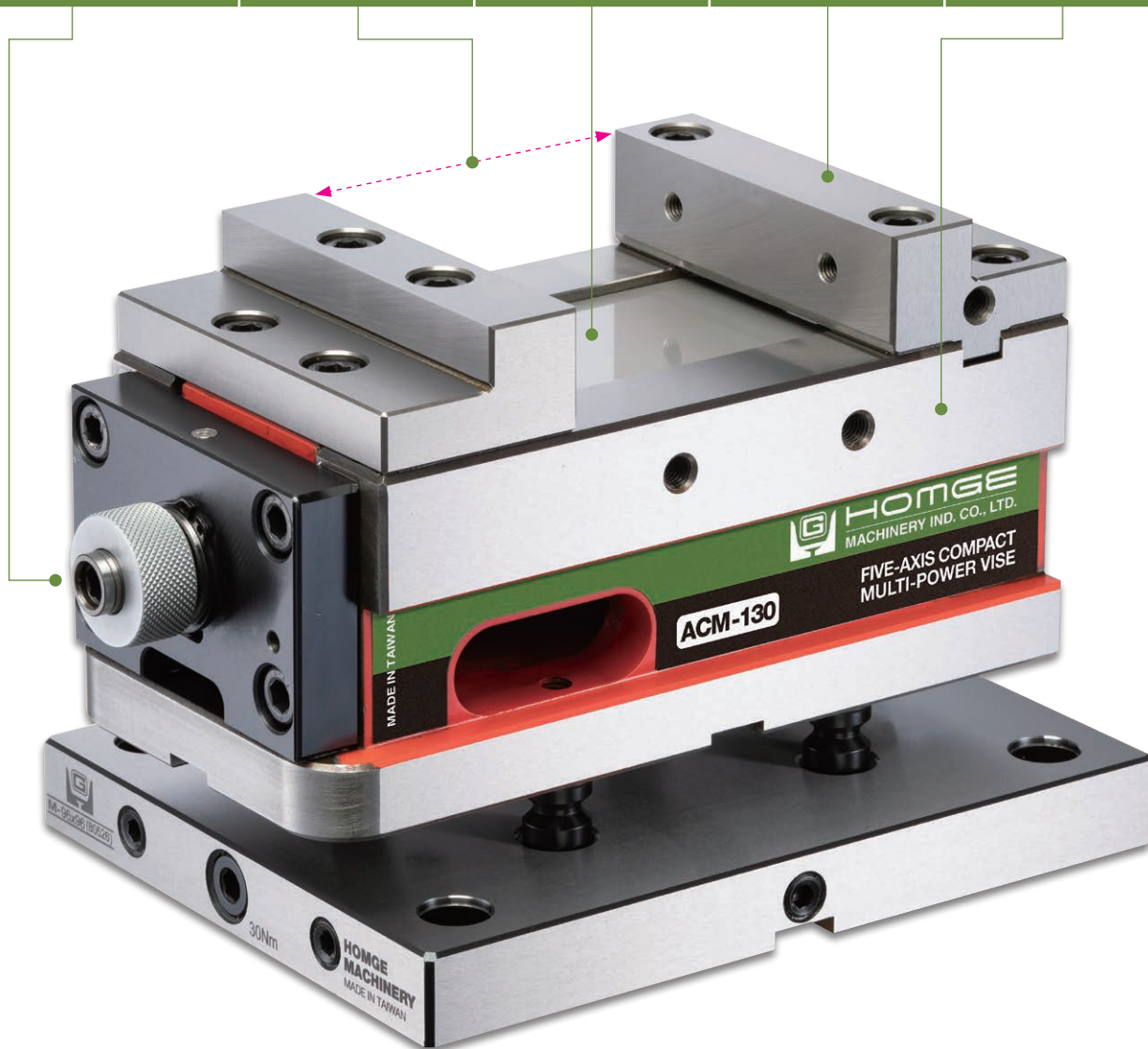

Compatible with zero-point quick change devices.
Using with M-96x96 (8066, 8067, 8057) is recommended.

Optional Accessories

Clamping Jaws

26

FIVE-AXIS COMPACT MULTI-POWER VISE / OPTIONAL ACCESSORIES

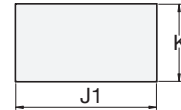
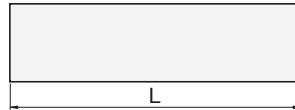

SPECIFICATIONS

Unit: mm

for Model	J1	K	L	Weight (kg)
ACM-130	62	34	128	5
ACM-160	80	50	158	11

Soft Jaws

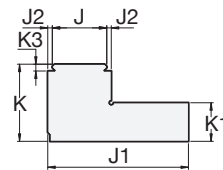
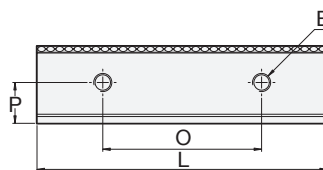

SPECIFICATIONS

Unit: mm

for Model	E	J	J1	J2	K	K1	K3	L	O	P	Weight (kg)
ACM-130	M8	24	62	2	34	17	3	128	70	18	3
ACM-160	M10	35	80	2.5	50	25	3	158	90	25	7

Serrated Jaws

OPTIONAL ACCESSORIES:

- Rectangular Plate
- Multi Plate
- Pull Studs

Please refer to Page 34
Zero Point Quick Change Devices

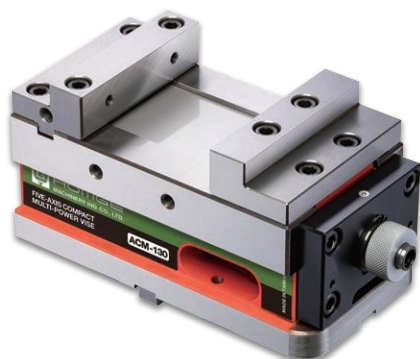
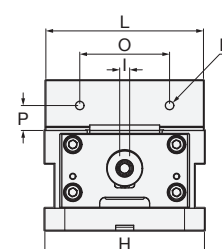
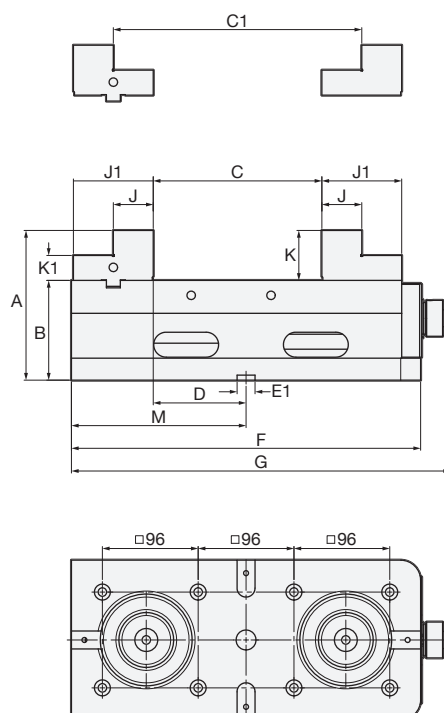
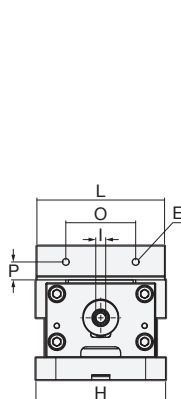
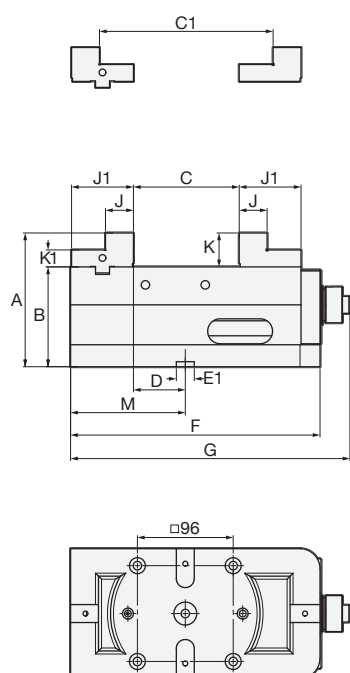
**ACM-130****ACM-160****SPECIFICATIONS** (Material: Vise body: Ductile Iron FCD60. Rail hardness: HRC 50 / Jaws SCM440. Hardness: HRC 50-52)

Unit: mm

Model	A	B	C	C1	D	E	E1	F	G	H	I	J	J1	K
ACM-130	134	100	105	173	52	M8	18	250	263	130	10	28	62	34
ACM-160	150	100	167	247	93	M10	18	350	363	160	10	40	80	50

Model	K1	L	M	O	P	Pull Studs	Max. Clamping Force	Weight (kg)
ACM-130	17	128	115	70	18	M-96x96PS	5000kg	22
ACM-160	25	158	175	90	25	M-96x96PS	5000kg	40