

FIVE-AXIS COMPACT MULTI-POWER VISE

Model: ACM-130, 160

16

FIVE-AXIS COMPACT MULTI-POWER VISE

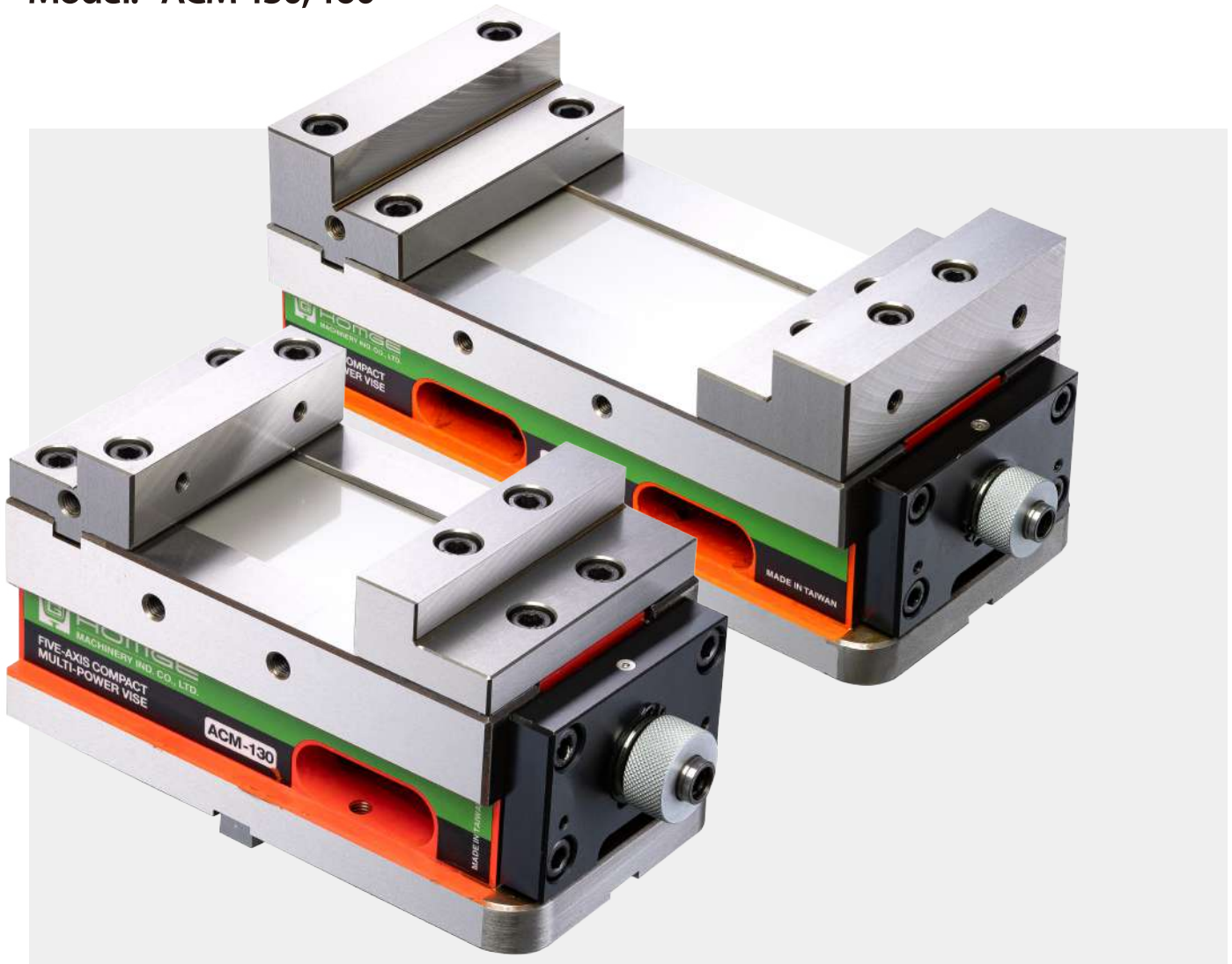

- Suitable for CNC 5-Axis Machining Centers, horizontal and vertical CNC Machining Centers
- Shortest Length with **Big Jaw Opening**
- Extremely High Accuracy and Repeatability
- Special MULTI-POWER design enhances clamping force of **0~5000KG**

OPTIONAL ACCESSORIES:



- Soft Jaws



- Serrated Jaws

STANDARD ACCESSORIES:

- 2 pcs of Alignment Wedge
- 4 pcs of Clamp
- 1 pc of Wrench

Vise body is made of **Ductile Iron** above **FCD 60** grade and its slideways are **hardened to HRC 52**, which increase the tensile strength of the vise to ensure clamping accuracy.

Vise jaws are made of **High quality Tool Steel (SCM440)** and Hardened to achieve **HRC 55**, which makes vise clamp the workpieces easily and firmly.

Special Leadscrew Covers protect Leadscrew from swarf and avoid any possible damage to internal parts.

Compact design with **big jaw opening**, which enhances machine space utilization.

Constructed from High Grade **BEARING STEEL**, the patented **MULTIPOWER SYSTEM** doubles the clamping force of the vise, offering a clamping force range of **0 to 5000kg**. Additionally, this system guarantees a consistent application of pressure, effectively eliminating concerns related to oil leakage commonly associated with hydraulic vises.

1

2

3

4

5

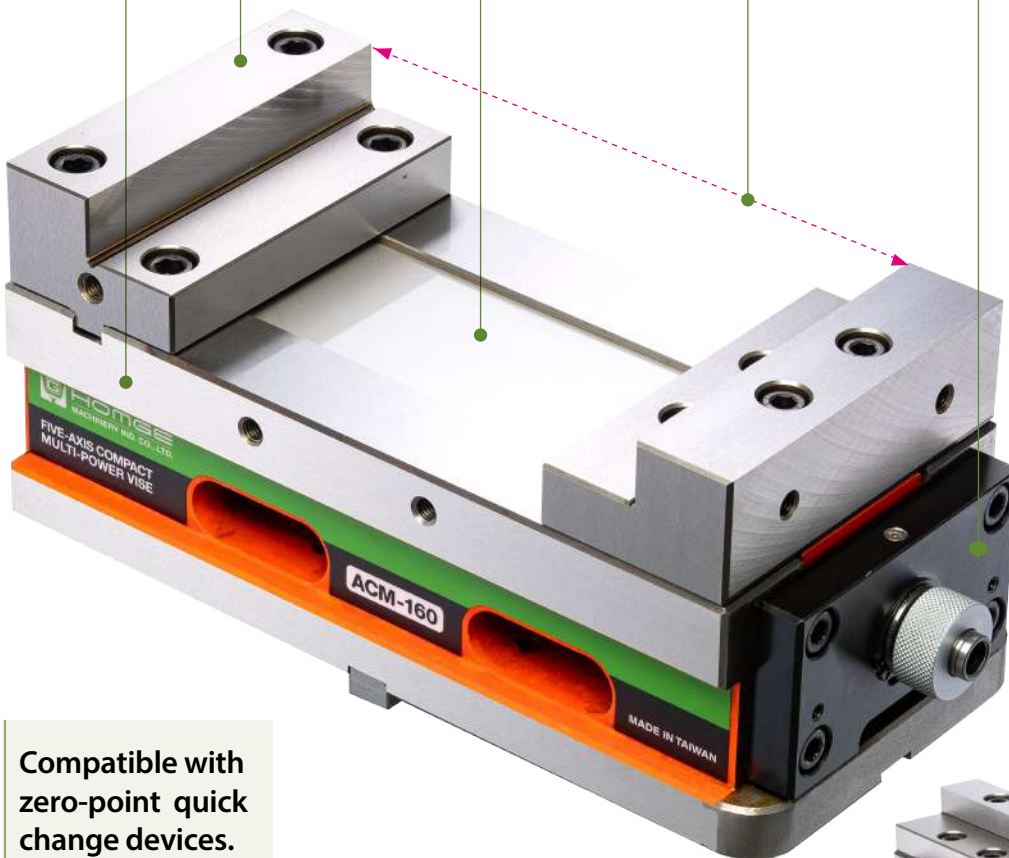

Compatible with zero-point quick change devices. Recommended for use with
 M-96x96 (8066)
 M-96x96 (8067)
 M-96x96 (8057)

6

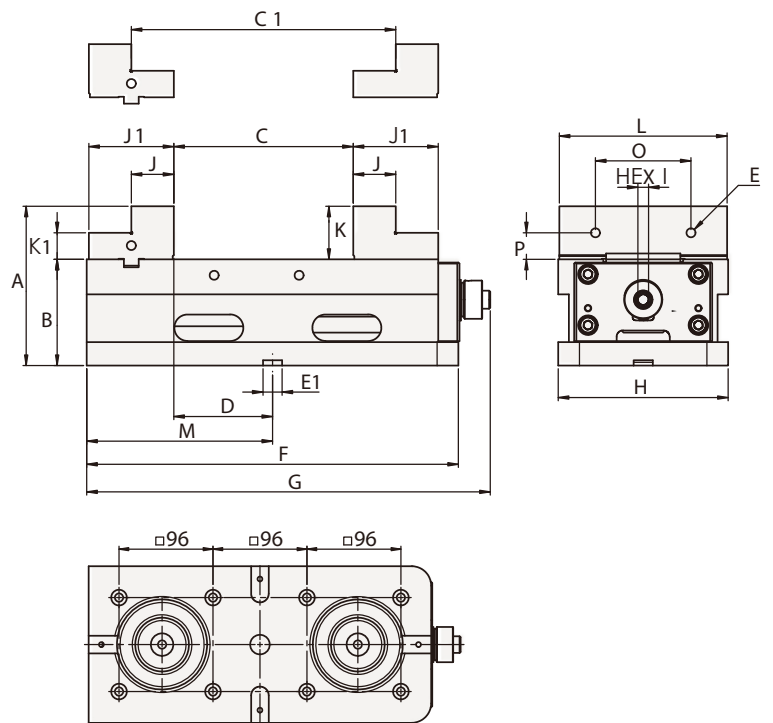
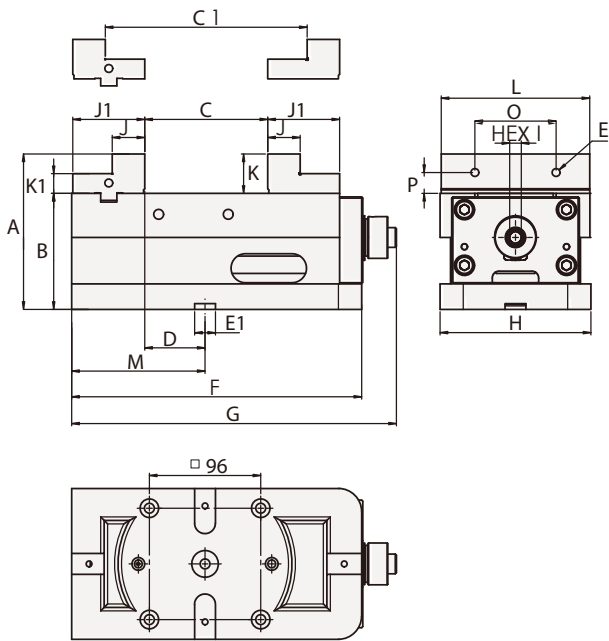

ACM-130

ACM-160

SPECIFICATIONS (Material: Vise body S50C: HRC 50 / Jaws SCM440: HRC 55)

Unit: mm

Model	A	B	C	C1	D	E	E1	F	G	H	I	J
ACM-130	134	100	105	173	52	M8	18	250	263	130	10	28
ACM-160	150	100	167	247	93	M10	18	350	363	160	10	40

Model	J1	K	K1	L	M	O	P	Pull Studs	Max. Clamping Force	Weight (kg)
ACM-130	62	34	17	128	115	70	18	263	5000kg	22
ACM-160	80	50	25	158	175	90	25	363	5000kg	40